

12.14 Model Integrated Text

BIM General Notations:

Any notation that will populate multiple sheets shall be put on views that allow duplication of the notations on multiple sheets. See image to right for an example.

BIM Sheet Notes:

Element-based schedules shall be used for notation that is specific per sheet.

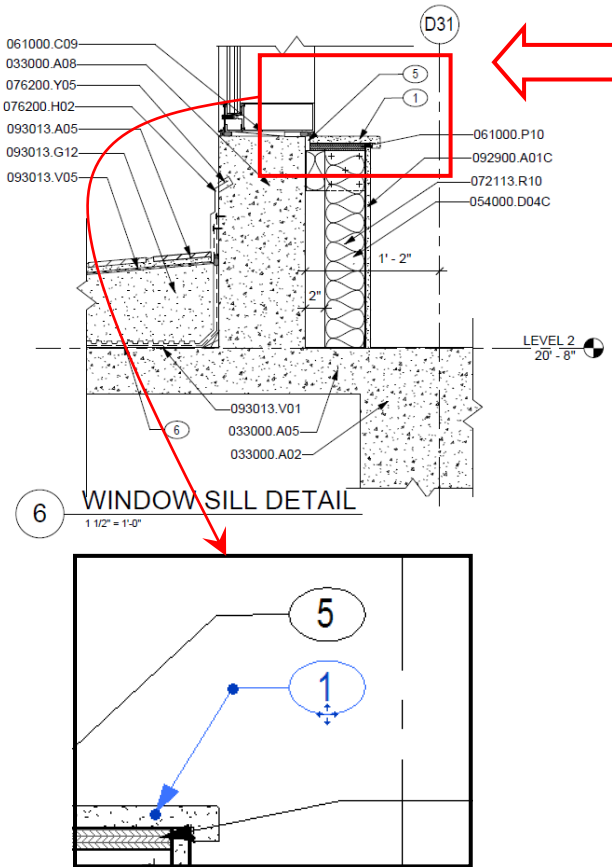

NOTES:

SHEET NOTES:

- A. REFER TO SHEET G-011 FOR GENERAL ABBREVIATIONS AND ARCHITECTURAL SYMBOLS.
- B. EXTEND GYPSUM BOARD TO BOTTOM OF CEILING PLATFORM IN AREAS WHERE NO CEILING IS SCHEDULED.
- C. REFER TO FINISH SCHEDULE SHEETS H-IN6 SERIES FOR FINISH INFORMATION.
- D. SEE SHEETS H-LS1.0FA THRU H-LS1.5FE FOR LIFE SAFETY PLANS.

Notation Object's Parameters:

Sheet Number	H-AE5.170
Number	1
Description	SOLID SURFACE STOOL ON PLYWOOD SUBSTRATE

00 KEYNOTES

- 1 SOLID SURFACE STOOL ON PLYWOOD SUBSTRATE
- 2 REFER TO REFLECTED CEILING PLANS FOR CEILING HEIGHTS
- 3 DRAPERY POCKET
- 4 PARTITION TYPE 77c
- 5 HOLD BACK OF STOOL & PLYWOOD 1/2" FROM CONCRETE CURB AND LOOSE PACK w/INSULATION
- 6 DRAINAGE MAT

BIM Material Notation:

Rather than using loose text, BIM software allows model objects to be linked from the object's parameters to an editable text file that holds specification data for Construction Document notation purpose. This notation has the ability to be shown by either numeric specification section or object description:

